

- GENERAL NOTES**
- This plan does not depict the exact location or size of existing utilities on the site or within the street. It is the contractor's responsibility to verify and record the location of each utility.
- LAYOUT NOTES**
- For Property Boundaries, see Plot Plan by Precision Land Surveying, Inc., dated 18 November 2020.
 - Examine the areas and conditions under which site work is to be performed. Report any discrepancies with the plan to the Landscape Designer. Do not proceed with the work until unsatisfactory conditions are corrected.
 - All hardscape shall be staked for approval by Landscape Designer before any construction begins. The contractor shall verify the layout of all site elements and report conflicts to the landscape designer.

LEGEND

	Property Line
	Limit of Work
	Existing Contours
	Change of slope
	Existing Tree
	Bluestone
	Existing Granite
	New Granite
	Gravel
	Concrete
	Bituminous Asphalt
	Granite Curbstone

- REVISIONS 2/5/2025
- REVISIONS 8/15/2025
- REVISIONS 2/1/2026

MATERIALS AND LAYOUT PLAN

L2.0

CONCORD CENTER FOR THE VISUAL ARTS
37 LEXINGTON ROAD
CONCORD, MA 01742

PREPARED BY KRISTAN FIRST
KRISTAN FIRST LANDSCAPE DESIGN

OCTOBER 10, 2022
REVISED MARCH 30, 2023; JUNE 10, 2024;
AUGUST 16, 2024; OCTOBER 21, 2024;
FEBRUARY 5, 2025; AUGUST 15, 2025;
FEBRUARY 1, 2026

SCALE: 1/8" = 1'-0"

Lorem ipsum

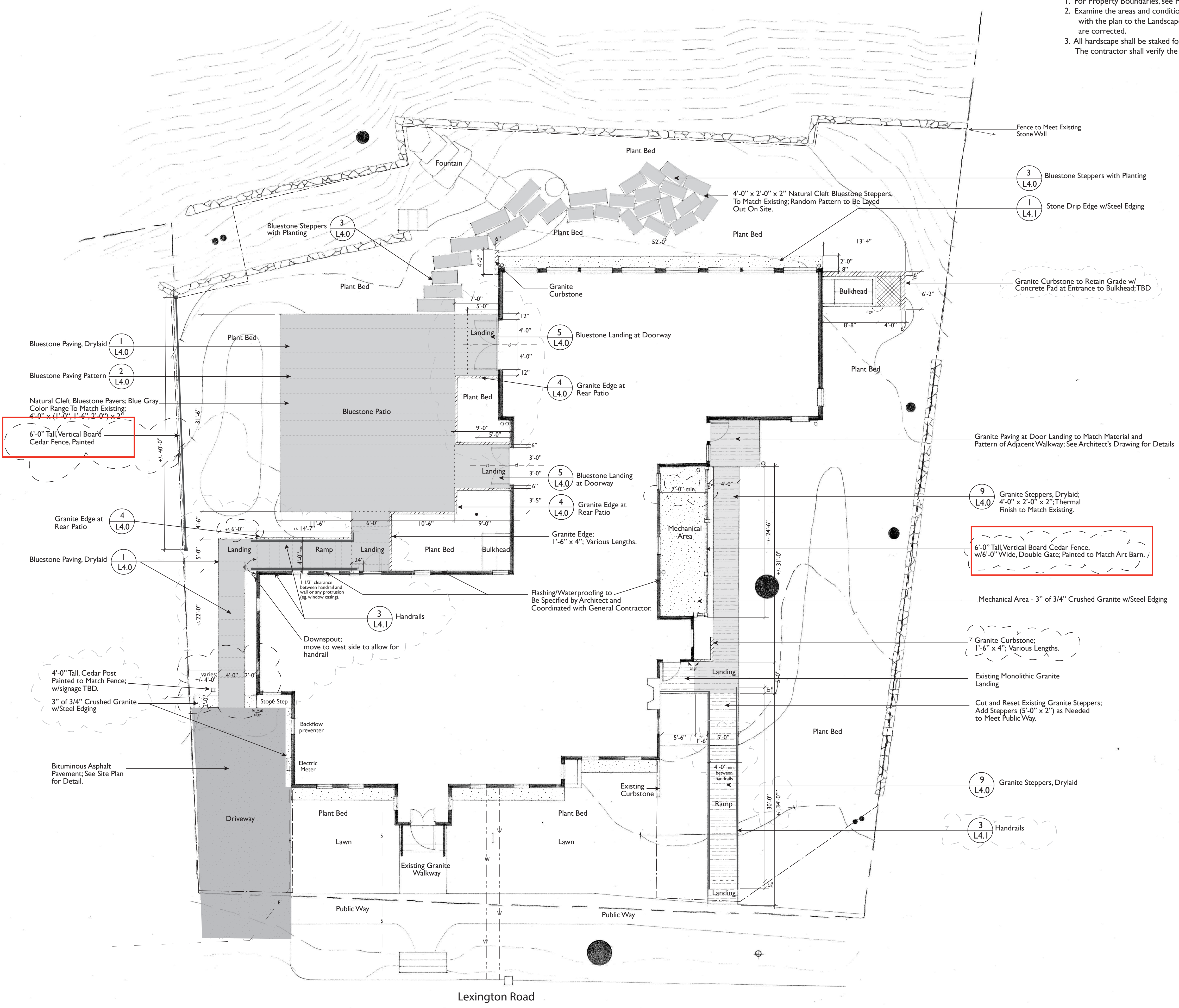

Lexington Road