

| STATE            | FED. AID PROJ. NO. | SHEET NO. | TOTAL SHEETS |
|------------------|--------------------|-----------|--------------|
| MA               | ----               | 6         | 328          |
| PROJECT FILE NO. |                    | 605189    |              |

TYPICAL SECTIONS

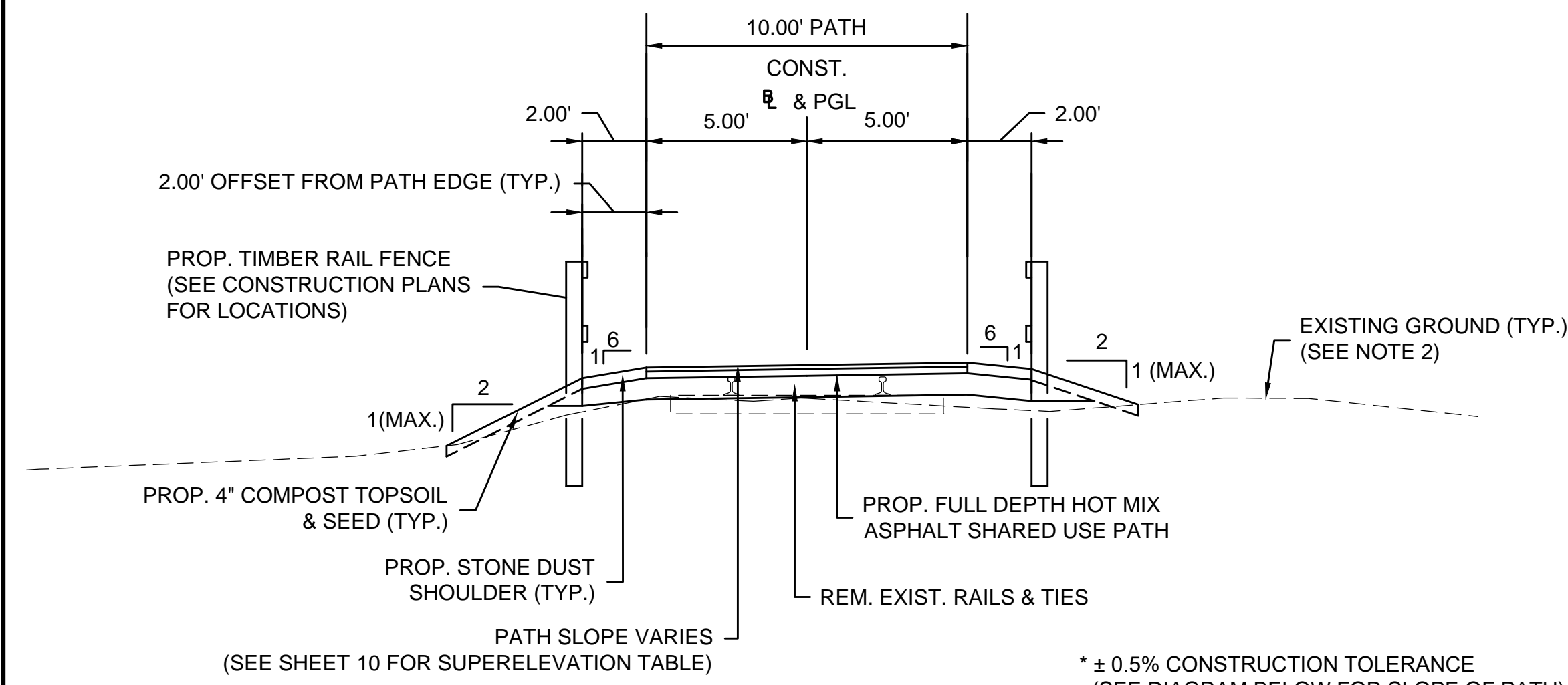

**FILL SECTION**

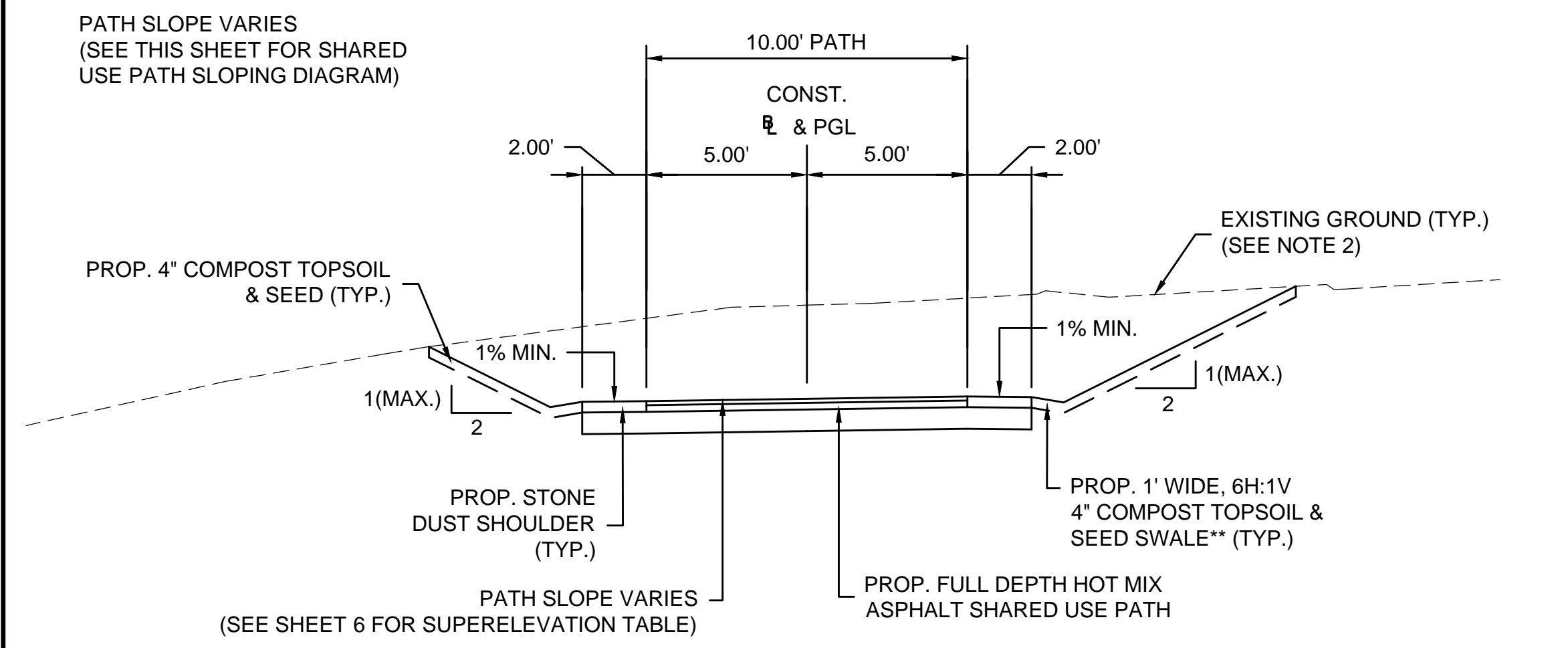

**CUT SECTION**

**TYPICAL SECTION - 10' WIDE PATH**

SCALE 1" = 4'  
 STA. 27+40± - STA. 28+54±  
 STA. 29+23± - STA. 75+79±  
 STA. 76+22± - STA. 103+31±  
 STA. 103+69± - STA. 116+13±  
 STA. 117+66± - STA. 124+27±  
 STA. 140+41± - STA. 159+71±  
 STA. 160+04± - STA. 163+80±  
 (SEE NOTE 1)

**PAVEMENT NOTES**

**FULL DEPTH HOT MIX ASPHALT SHARED USE PATH**

SURFACE COURSE: 1-3/4" SUPERPAVE SURFACE COURSE - 9.5 (SSC-9.5) OVER  
 INTERMEDIATE COURSE: 2-1/4" SUPERPAVE INTERMEDIATE COURSE - 19.0 (SIC-19.0) OVER  
 FOUNDATION: 2" - 8" GRAVEL BORROW (M1.03.0 TYPE B) (SEE NOTE BELOW) OVER SPECIAL BORROW AS REQUIRED (SEE NOTE BELOW)

NOTE: SUBBASE SHALL BE A MINIMUM OF 2" GRAVEL BORROW FOR LEVELING OVER RAILROAD BALLAST. SUBBASE SHALL BE 8" GRAVEL BORROW OVER SPECIAL BORROW AT FILL SECTIONS IN AREAS OF WETLANDS AND OTHER UNSUITABLE MATERIAL IN ACCORDANCE WITH SECTION 150 AND 170 OF THE STANDARD SPECIFICATIONS FOR HIGHWAYS AND BRIDGES.

**PAVED SHARED USE PATH OVER BRIDGES (OVER THE NASHOBA BROOK, SEE BRIDGE PLANS FOR DETAILS)**

SURFACE COURSE: 1-3/4" SUPERPAVE SURFACE COURSE - 9.5 (SSC-9.5) OVER  
 INTERMEDIATE COURSE: 2-1/4" SUPERPAVE INTERMEDIATE COURSE - 19.0 (SIC-19.0) OVER  
 FOUNDATION: VARIABLE DEPTH CRUSHED STONE (M2.01.1) OVER 2" SAND OVER MEMBRANE WATERPROOFING OVER EXISTING 8" REINFORCED CONCRETE DECK

**FULL DEPTH HOT MIX ASPHALT CONSTRUCTION (AT ROADWAY CROSSINGS & MAIN ST. AND COMM. AVE.)**

SURFACE COURSE: 1-3/4" SUPERPAVE SURFACE COURSE - 9.5 (SSC-9.5) OVER 1-3/4" SUPERPAVE SURFACE COURSE - 9.5 (SSC-9.5) OVER  
 INTERMEDIATE COURSE: 3" SUPERPAVE INTERMEDIATE COURSE - 19.0 (SIC-19.0) OVER 3" SUPERPAVE INTERMEDIATE COURSE - 19.0 (SIC-19.0) OVER  
 SUBBASE: 4" DENSE GRADED CRUSHED STONE FOR SUB-BASE OVER 8" GRAVEL BORROW (M1.03.0 TYPE B)

**FULL DEPTH WIDENING LESS THAN 4 FEET**

SURFACE COURSE: 1-3/4" SUPERPAVE SURFACE COURSE - 9.5 (SSC-9.5) OVER 1-3/4" SUPERPAVE SURFACE COURSE - 9.5 (SSC-9.5) OVER  
 BASE: 6" HIGH-EARLY-STRENGTH CEMENT CONCRETE BASE COURSE OVER  
 SUBBASE: 8" GRAVEL BORROW (M1.03.0 TYPE B)

**FULL DEPTH HOT MIX ASPHALT RAILROAD GRADE CROSSING (MAIN ST. & COMM. AVE.)**

SURFACE COURSE: 2" SUPERPAVE SURFACE COURSE - 9.5 (SSC-9.5) OVER  
 INTERMEDIATE COURSE: 6" SUPERPAVE INTERMEDIATE COURSE - 19.0 (SIC-19.0) PLACED IN TWO 3" LIFTS OVER  
 FOUNDATION: EXISTING BALLAST

**PAVEMENT MICROMILLING & RESURFACING (MAIN ST. & COMM. AVE.)**

SURFACE COURSE: 1-3/4" SUPERPAVE SURFACE COURSE - 9.5 (SSC-9.5)  
 SURFACE MILLING: 1-3/4" PAVEMENT MICRO-MILLING TO MATCH EXISTING CROSS SLOPE

**STONE DUST SHOULDER**

SURFACE: 4" STONE DUST (SPECIAL PROVISION ITEM 704.2) OVER GEOTEXTILE FABRIC FOR SEPARATION OVER  
 FOUNDATION: 2" - 8" GRAVEL BORROW (M1.03.0 TYPE B) (SEE NOTE UNDER FULL DEPTH HOT MIX ASPHALT SHARED USE PATH)

**CEMENT CONCRETE SIDEWALKS, REST AREAS & WHEELCHAIR RAMPS:**

SURFACE COURSE: 4" CEMENT CONCRETE (AIR ENTRAINED 4000 PSI, 3/4", 610) OVER  
 SUBBASE: 8" GRAVEL BORROW (M1.03.0 TYPE B)

**PROPOSED CEMENT CONCRETE SIDEWALK AT DRIVEWAYS**

SURFACE: 6" CEMENT CONCRETE (AIR ENTRAINED 4000 PSI, 3/4", 610) OVER  
 FOUNDATION: 8" GRAVEL BORROW (TYPE B)

**COBBLE STONE SPLITTER ISLANDS:**

SURFACE COURSE: 4" COBBLE STONE OVER  
 SUBBASE: 4" CEMENT CONCRETE (AIR ENTRAINED 4000 PSI, 3/4", 610)

**HOT MIX ASPHALT SIDEWALKS**

SURFACE: 1" SUPERPAVE SURFACE COURSE - 9.5 (SSC-9.5) OVER 1-1/2" SUPERPAVE INTERMEDIATE COURSE 12.5 (SIC-12.5) OVER  
 SUBBASE: 8" GRAVEL BORROW (M1.03.0 TYPE B OR EXISTING GRAVEL BORROW TO REMAIN)

**HOT MIX ASPHALT DRIVEWAYS**

SURFACE COURSE: 1-1/2" SUPERPAVE SURFACE COURSE 9.5 (SSC-9.5) OVER  
 INTERMEDIATE COURSE: 2" SUPERPAVE INTERMEDIATE COURSE 12.5 (SIC-12.5) OVER  
 FOUNDATION: 8" GRAVEL BORROW (M1.03.0 TYPE B)

**FULL DEPTH HOT MIX ASPHALT PARKING LOTS**

SURFACE COURSE: 1-1/2" SUPERPAVE SURFACE COURSE 12.5 (SSC-12.5) OVER  
 INTERMEDIATE COURSE: 2-1/2" SUPERPAVE INTERMEDIATE COURSE 19.0 (SIC-19.0) OVER  
 FOUNDATION: 8" GRAVEL BORROW (M1.03.0 TYPE B) FOR LEVELING

**PERVIOUS PAVERS**

SURFACE COURSE: POROUS PAVER (SPECIAL PROVISION ITEM 708.35) OVER  
 FOUNDATION: 2" DOUBLE WASHED 1/4" LEVELING STONE OVER 4" DOUBLE WASHED 3/4" STONE OVER 18" DOUBLE WASHED 1" TO 1-1/2" CRUSHED STONE OVER  
 SUBBASE: GRAVEL BORROW (M1.03.0 TYPE B) AS REQUIRED

**TACK COAT**

ASPHALT EMULSION FOR TACK COAT (RS-1H) SHALL BE APPLIED PRIOR TO PAVING HMA OVERLAYS TO BOND LAYERS FOR FLEXURAL STRENGTH. HMA JOINT SEALANT SHALL BE APPLIED TO ALL JOINTS PRIOR TO PAVING THE SURFACE COURSE. ASPHALT EMULSION FOR TACK COAT (RS-1H) SHALL BE APPLIED AT THE RATE OF 0.07 GAL/S.Y. FOR MILLED SURFACES AND 0.05 GAL/S.Y. FOR SMOOTH TIGHT PAVED SURFACES.

**NOTES:**

- THE SECTIONS OF PROPOSED ROADWAY NOT COVERED IN THE RANGE OF STATIONS ASSOCIATED WITH THE TYPICAL SECTIONS ARE EITHER IN TRANSITION OR ARE LOCATED AT INTERSECTIONS AND THEREFORE HAVE NOT BEEN SHOWN. REFER TO CROSS SECTION SHEETS FOR MORE DETAILS.
- CONTRACTOR SHALL REMOVE EXISTING ORGANIC MATERIAL (ABOVE RAILROAD BALLAST) THAT IS UNSUITABLE FOR REUSE AND DISPOSE OF OUTSIDE OF THE PROJECT LIMITS. IT IS ASSUMED THAT ALL OTHER EXCAVATED SUITABLE MATERIAL WILL REMAIN WITHIN THE PROJECT LIMITS. SEE SPECIAL PROVISIONS FOR DETAILS.

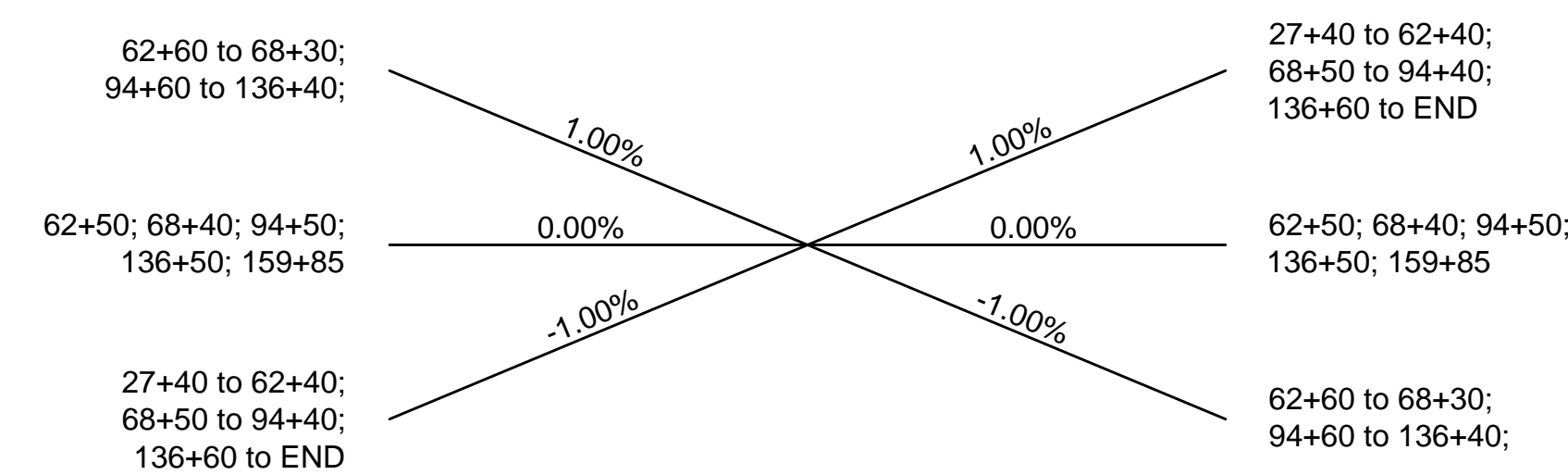

**SHARED USE PATH SLOPING**

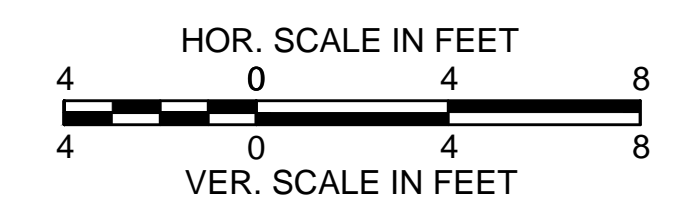

| STATE            | FED. AID PROJ. NO. | SHEET NO. | TOTAL SHEETS |
|------------------|--------------------|-----------|--------------|
| MA               | ----               | 7         | 328          |
| PROJECT FILE NO. |                    | 605189    |              |

TYPICAL SECTIONS

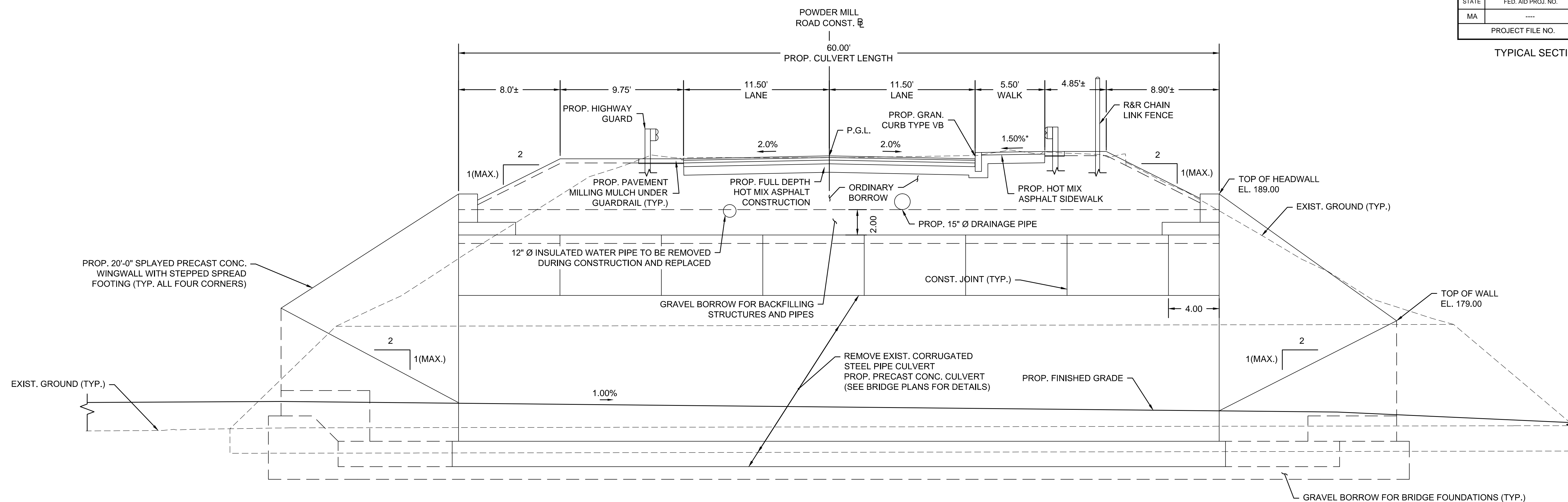

TYPICAL SECTION -  
POWDER MILL ROAD  
SCALE 1" = 4'

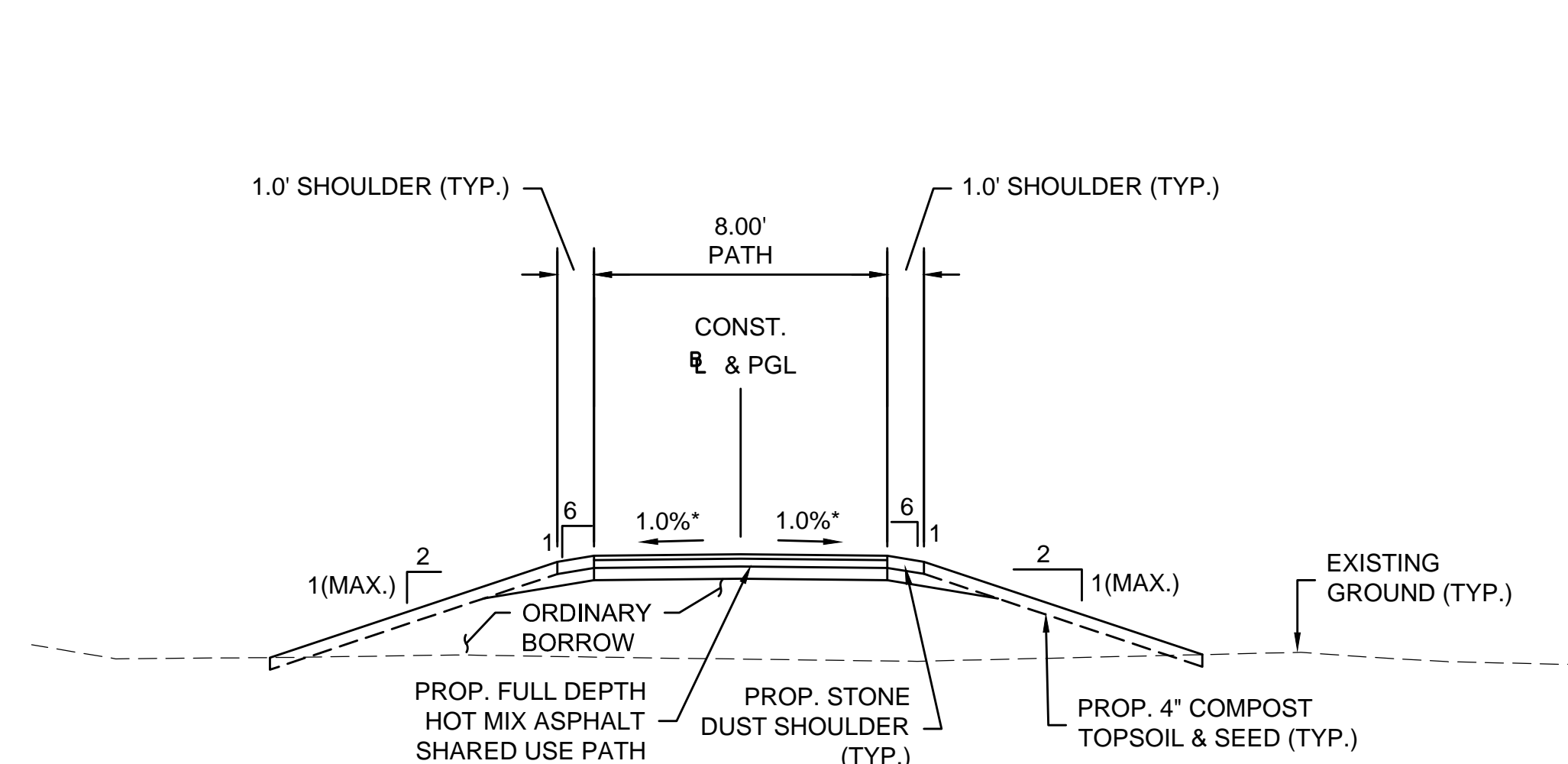

TYPICAL SECTION - 8' PATH  
(POWDER MILL ROAD ACCESS PATH)

SCALE 1" = 4'  
STA. 300+00± - STA. 301+29±  
STA. 301+70± - STA. 302+32±  
STA. 302+72± - STA. 305+50±

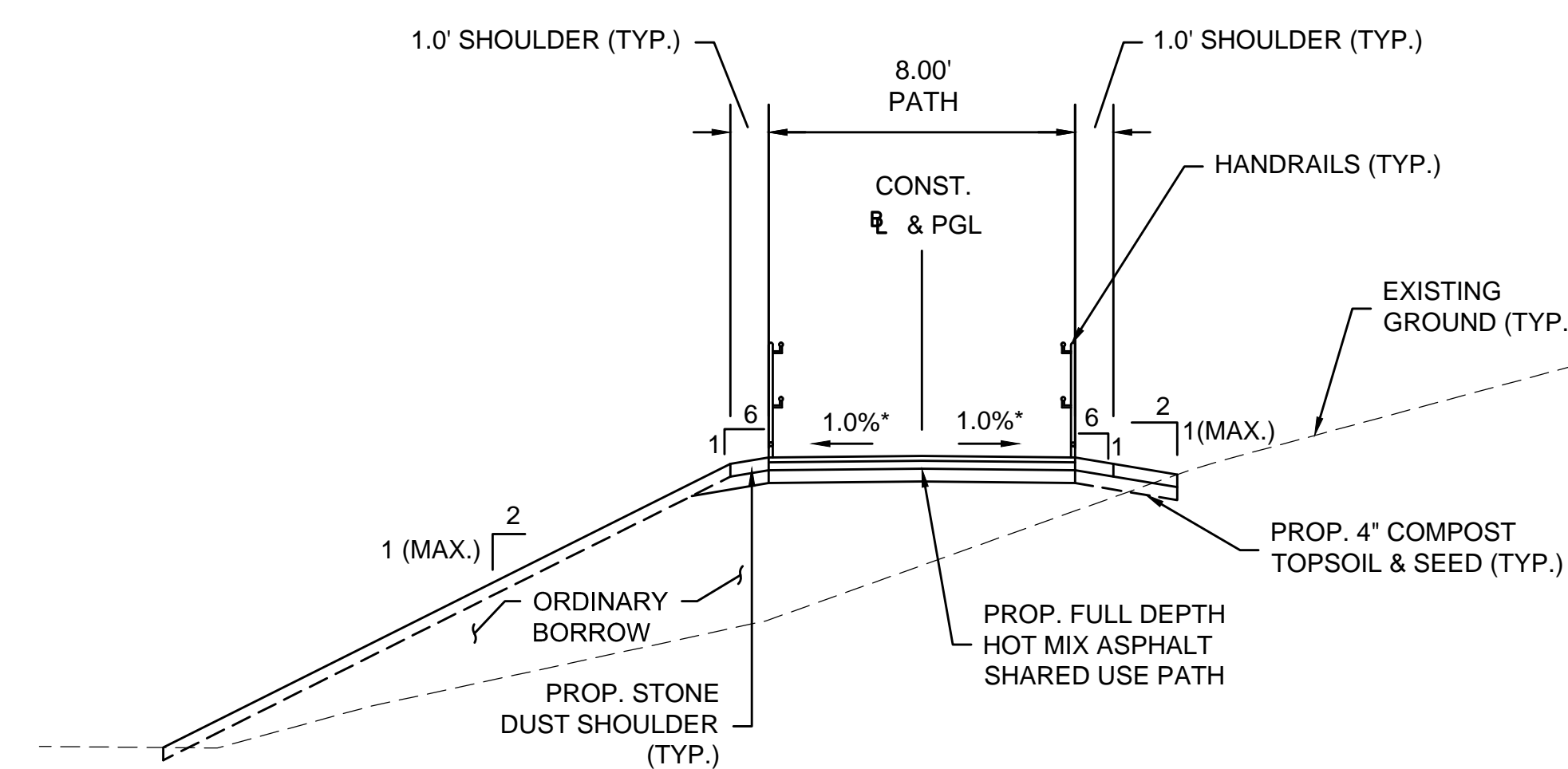

TYPICAL SECTION - 8' RAMP  
(POWDER MILL ROAD ACCESS PATH)

SCALE 1" = 4'  
POWDER MILL STA. 301+29± - STA. 301+70±  
POWDER MILL STA. 302+32± - STA. 302+72±

NOTES:

1. THE SECTIONS OF PROPOSED ROADWAY NOT COVERED IN THE RANGE OF STATIONS ASSOCIATED WITH THE TYPICAL SECTIONS ARE EITHER IN TRANSITION OR ARE LOCATED AT INTERSECTIONS AND THEREFORE HAVE NOT BEEN SHOWN. REFER TO CROSS SECTION SHEETS FOR MORE DETAILS.
2. CONTRACTOR SHALL REMOVE EXISTING ORGANIC MATERIAL (ABOVE RAILROAD BALLAST) THAT IS UNSUITABLE FOR REUSE AND DISPOSE OF OUTSIDE OF THE PROJECT LIMITS. IT IS ASSUMED THAT ALL OTHER EXCAVATED SUITABLE MATERIAL WILL REMAIN WITHIN THE PROJECT LIMITS. SEE SPECIAL PROVISIONS FOR DETAILS.

\* ± 0.5% CONSTRUCTION TOLERANCE

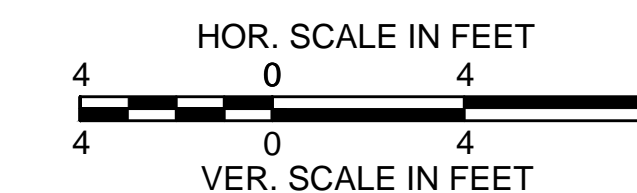

| STATE            | FED. AID PROJ. NO. | SHEET NO. | TOTAL SHEETS |
|------------------|--------------------|-----------|--------------|
| MA               | ----               | 8         | 328          |
| PROJECT FILE NO. |                    | 605189    |              |

TYPICAL SECTIONS

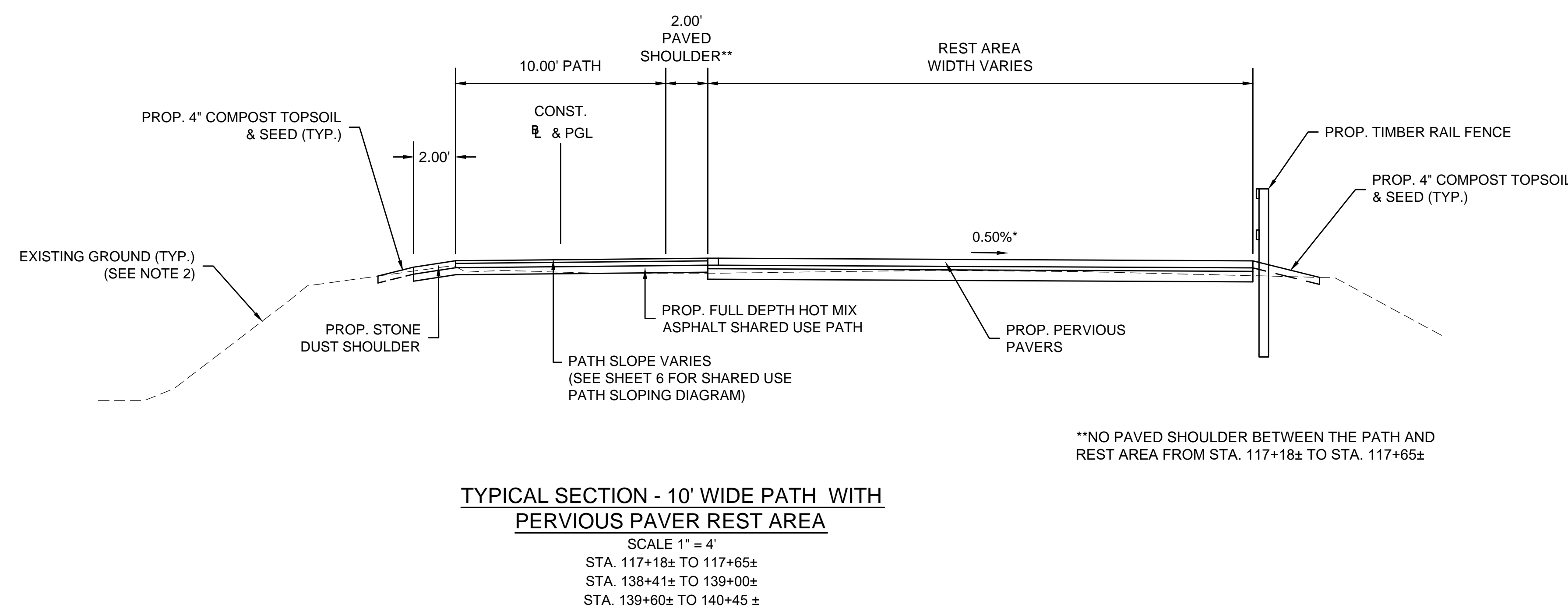
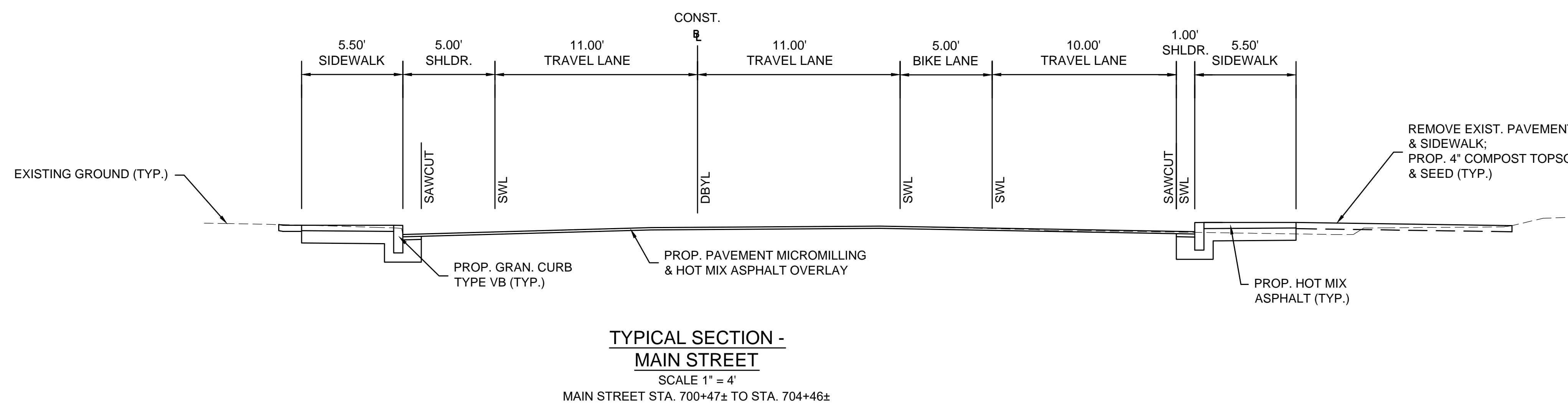

NOTES:

1. THE SECTIONS OF PROPOSED ROADWAY NOT COVERED IN THE RANGE OF STATIONS ASSOCIATED WITH THE TYPICAL SECTIONS ARE EITHER IN TRANSITION OR ARE LOCATED AT INTERSECTIONS AND THEREFORE HAVE NOT BEEN SHOWN. REFER TO CROSS SECTION SHEETS FOR MORE DETAILS.
2. CONTRACTOR SHALL REMOVE EXISTING ORGANIC MATERIAL (ABOVE RAILROAD BALLAST) THAT IS UNSUITABLE FOR REUSE AND DISPOSE OF OUTSIDE OF THE PROJECT LIMITS. IT IS ASSUMED THAT ALL OTHER EXCAVATED SUITABLE MATERIAL WILL REMAIN WITHIN THE PROJECT LIMITS. SEE SPECIAL PROVISIONS FOR DETAILS.

\* ± 0.5% CONSTRUCTION TOLERANCE

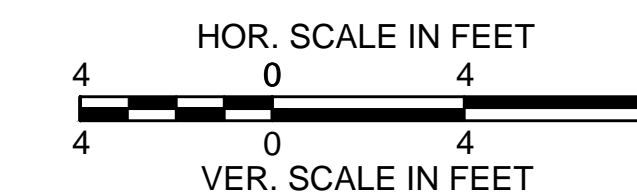

| STATE            | FED. AID PROJ. NO. | SHEET NO. | TOTAL SHEETS |
|------------------|--------------------|-----------|--------------|
| MA               | ----               | 9         | 328          |
| PROJECT FILE NO. |                    | 605189    |              |

TYPICAL SECTIONS

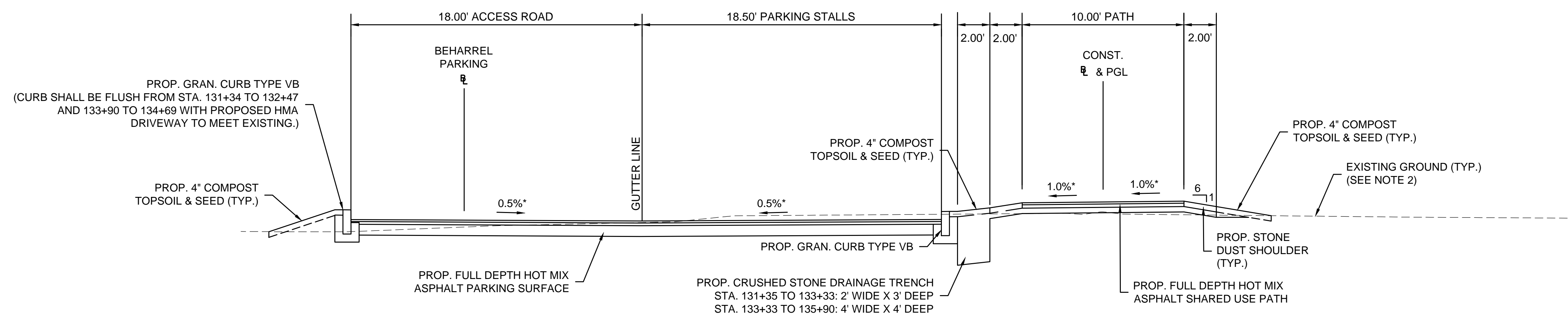

TYPICAL SECTION - 10' WIDE PATH AT  
BEHARRELL STREET PARKING

SCALE 1" = 4'  
STA. 131+19± - STA. 136+39±

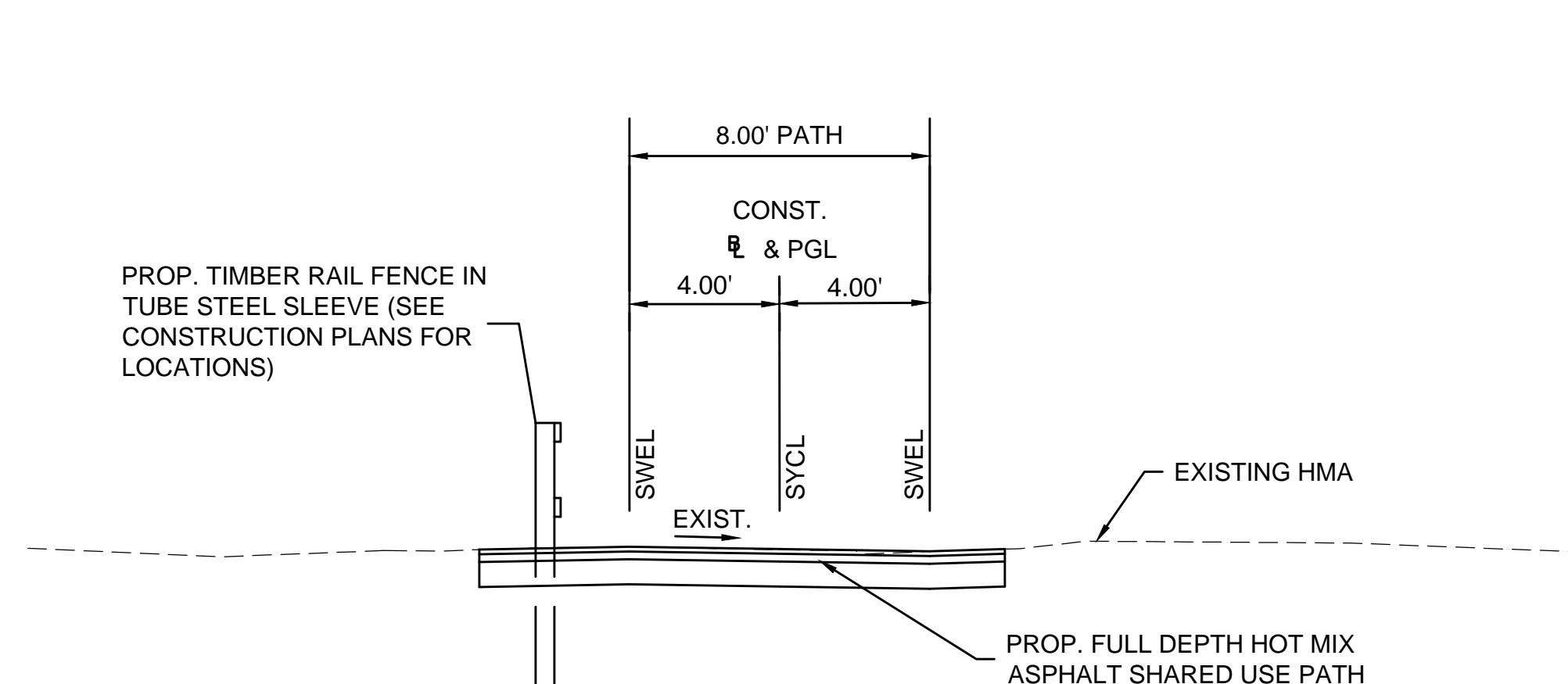

TYPICAL SECTION - 8' WIDE PATH  
THROUGH WEST CONCORD CENTER

SCALE 1" = 4'  
STA. 126+67± - STA. 129+48±

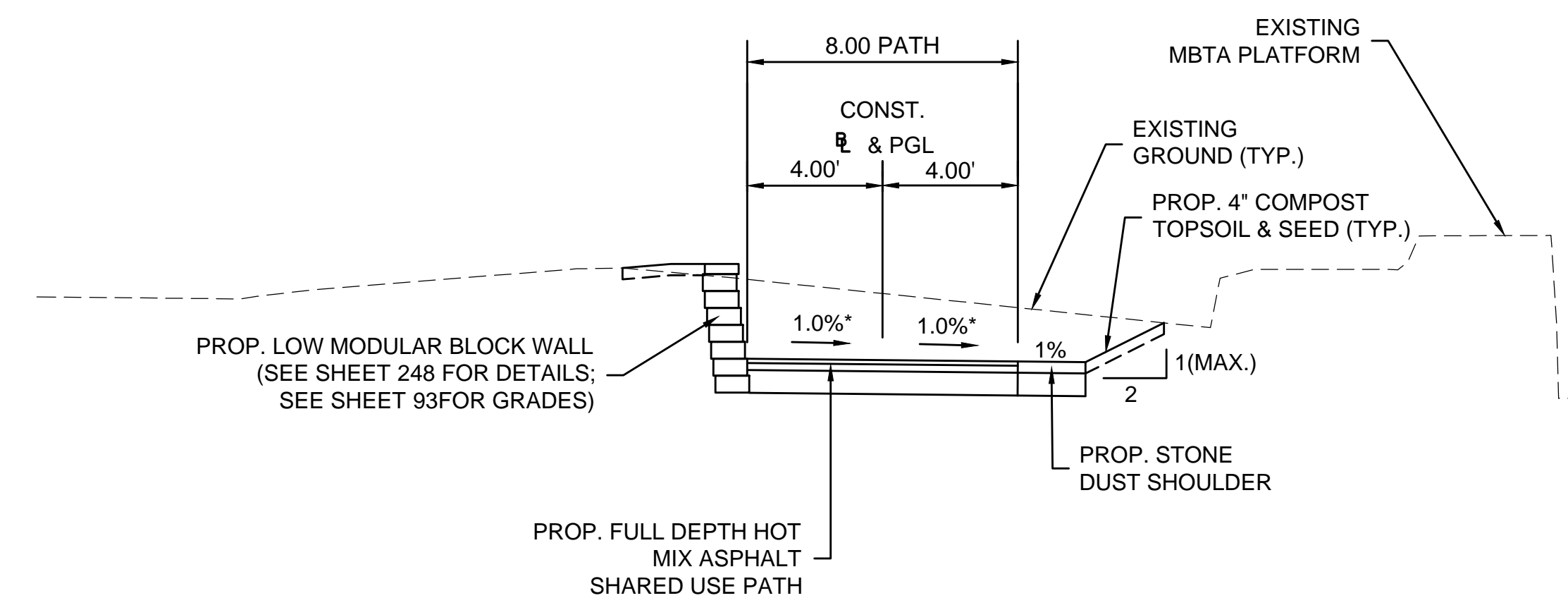

TYPICAL SECTION - 8' WIDE PATH  
CUT SECTION WITH LOW RETAINING WALL

SCALE 1" = 4'  
STA. 129+48± - STA. 129+96±

NOTES:

1. THE SECTIONS OF PROPOSED ROADWAY NOT COVERED IN THE RANGE OF STATIONS ASSOCIATED WITH THE TYPICAL SECTIONS ARE EITHER IN TRANSITION OR ARE LOCATED AT INTERSECTIONS AND THEREFORE HAVE NOT BEEN SHOWN. REFER TO CROSS SECTION SHEETS FOR MORE DETAILS.
2. CONTRACTOR SHALL REMOVE EXISTING ORGANIC MATERIAL (ABOVE RAILROAD BALLAST) THAT IS UNSUITABLE FOR REUSE AND DISPOSE OF OUTSIDE OF THE PROJECT LIMITS. IT IS ASSUMED THAT ALL OTHER EXCAVATED SUITABLE MATERIAL WILL REMAIN WITHIN THE PROJECT LIMITS. SEE SPECIAL PROVISIONS FOR DETAILS.

\* ± 0.5% CONSTRUCTION TOLERANCE

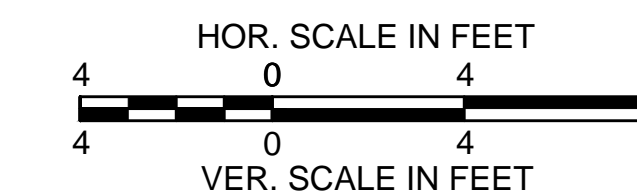

| STATE            | FED. AID PROJ. NO. | SHEET NO. | TOTAL SHEETS |
|------------------|--------------------|-----------|--------------|
| MA               | ----               | 10        | 328          |
| PROJECT FILE NO. |                    | 605189    |              |

TYPICAL SECTIONS

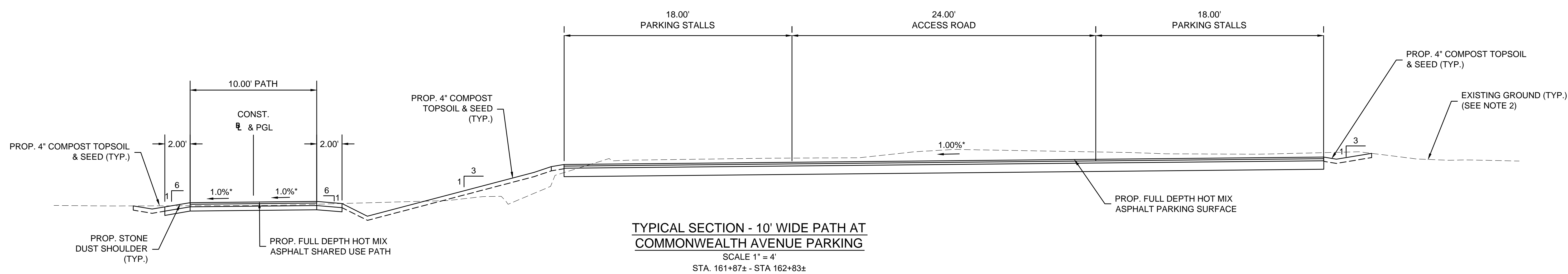
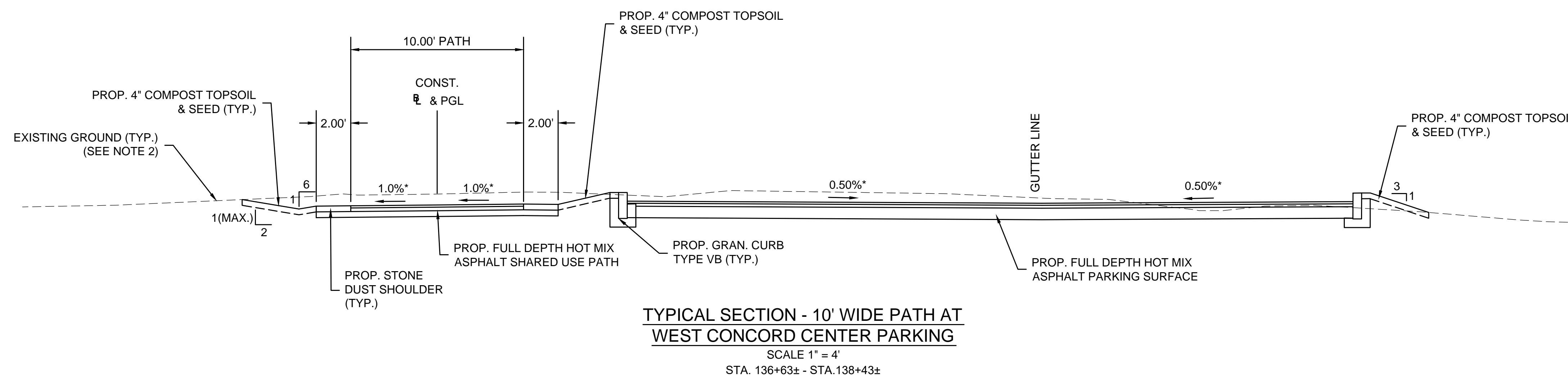

NOTES:

1. THE SECTIONS OF PROPOSED ROADWAY NOT COVERED IN THE RANGE OF STATIONS ASSOCIATED WITH THE TYPICAL SECTIONS ARE EITHER IN TRANSITION OR ARE LOCATED AT INTERSECTIONS AND THEREFORE HAVE NOT BEEN SHOWN. REFER TO CROSS SECTION SHEETS FOR MORE DETAILS.
2. CONTRACTOR SHALL REMOVE EXISTING ORGANIC MATERIAL (ABOVE RAILROAD BALLAST) THAT IS UNSUITABLE FOR REUSE AND DISPOSE OF OUTSIDE OF THE PROJECT LIMITS. IT IS ASSUMED THAT ALL OTHER EXCAVATED SUITABLE MATERIAL WILL REMAIN WITHIN THE PROJECT LIMITS. SEE SPECIAL PROVISIONS FOR DETAILS.

\* ± 0.5% CONSTRUCTION TOLERANCE

