

EXISTING LEGEND:

- 102--- SURFACE CONTOUR
- STONE WALL
- STONE RETAINING WALL
- 78.3 WFA2 LIMIT OF BORDERING VEGETATED WETLAND WITH FLAG NUMBER AND ELEVATION
- LIMIT OF 100-FOOT WETLAND BUFFER ZONE
- 104--- EDGE OF GRAVEL ROAD
- × 100.7 SPOT ELEVATION
- 12"DEC PROMINENT DECIDUOUS TREE WITH SIZE
- 18"CON PROMINENT CONIFEROUS TREE WITH SIZE
- CPP CORRUGATED PLASTIC PIPE
- (FD) FOUND
- DH DRILL HOLE
- DHSB DRILL HOLE IN STONE BOUND
- I.ROD IRON ROD
- CTR. BK. CENTER BACK
- PVC POLYVINYL CHLORIDE
- AC AIR CONDITIONER
- INV. INVERT
- VP VENT PIPE
- CONC. CONCRETE
- HL WATER LEVEL
- BH BULKHEAD
- TBM BENCHMARK
- S.F. SQUARE FEET
- AC ACRES
- SP SOLAR PANELS
- CB CORNER BOARD
- RO ROOF OVERHANG
- (TYP.) TYPICAL

ELEVATION BENCH MARKS		
DATUM: ASSUMED		
NO.	DESCRIPTION	ELEV.
1.	NORTHWEST CORNER OF GRANITE STEP	82.48
2.		
3.		

PROPOSED LEGEND:

- 100--- SURFACE CONTOUR
- S SEWER PIPE
- EROSION CONTROL LINE
- RETAINING WALL
- × 100.7 SPOT ELEVATION
- OPSCO SEWER CLEANOUT

NOTES:

- 1) ELEVATIONS SHOWN HEREON ARE REFERENCED TO AN ASSUMED DATUM.
- 2) UTILITIES ARE SHOWN HEREON FROM FIELD LOCATIONS OF SURFACE VISIBLE STRUCTURES. UNDERGROUND UTILITIES MAY EXIST. IT SHALL BE THE RESPONSIBILITY OF THE CONTRACTOR TO VERIFY THE LOCATION, SIZE & ELEVATION OF ALL UTILITIES WITHIN THE AREA OF PROPOSED WORK AND TO CONTACT "DIG-SAFE" AT 811 AT LEAST 72 HOURS PRIOR TO ANY EXCAVATION, DEMOLITION OR CONSTRUCTION.
- 3) THE LIMIT OF BORDERING VEGETATED WETLANDS SHOWN HEREON WAS DELINEATED BY HANCOCK ASSOCIATES AND LOCATED VIA AN ON-THE-GROUND INSTRUMENT SURVEY.
- 4) THE SURVEYED PREMISES AS SHOWN HEREON IS NOT LOCATED WITHIN A SPECIAL FLOOD HAZARD AREA, OR OTHER FLOOD AREA, AS SHOWN ON FEMA NATIONAL FLOOD INSURANCE PROGRAM (NFIP) FLOOD INSURANCE RATE MAP (FIRM) NUMBER 25017C0378F, HAVING AN EFFECTIVE DATE OF JULY 7, 2014.
- 5) THE EXISTING CONDITIONS SHOWN HEREON ARE THE RESULT OF AN ON-THE-GROUND INSTRUMENT SURVEY PERFORMED BY HANCOCK ASSOCIATES IN AUGUST OF 2019.
- 6) IT SHALL BE THE RESPONSIBILITY OF THE CONTRACTOR TO VERIFY THE ELEVATIONS OF THE EXISTING BUILDING SEWER OUTLET AND OF THE EXISTING PUMP CHAMBER INLET AND REPORT ANY DISCREPANCY TO THIS OFFICE PRIOR TO COMPLETING INSTALLATION.
- 7) ALL WORK OUTSIDE OF BUILDING THAT IS LESS THAN 10 FEET FROM THE INSIDE FACE OF BUILDING FOUNDATIONS SHALL CONFORM WITH THE UNIFORM STATE PLUMBING CODE OF MASSACHUSETTS, 248 CMR 2.00.
- 8) PROPOSED BUILDING FOUNDATION CONFIGURATION AND LOCATION ON THE LOT AS SHOWN ARE CONCEPTUAL AND SHALL BE VERIFIED AS TO CONFORMANCE WITH FINAL ARCHITECTURAL PLANS AND ZONING ORDINANCES PRIOR TO CONSTRUCTION.
- 9) CONTRACTOR SHALL FURNISH CONSTRUCTION LAYOUT OF BUILDING AND SITE IMPROVEMENTS. THIS WORK SHALL BE PERFORMED BY A PROFESSIONAL LAND SURVEYOR.
- 10) THIS PLAN IS NOT INTENDED TO SHOW AN ENGINEERED BUILDING FOUNDATION DESIGN, WHICH WOULD INCLUDE DETAILS AND FINAL ELEVATIONS OF FOOTINGS, WALLS AND SUBSURFACE DRAINAGE TO PREVENT INTERIOR FLOODING. SEE ARCHITECTURAL AND/OR STRUCTURAL DRAWINGS.
- 11) CONTRACTOR SHALL BE RESPONSIBLE FOR REPAIR AND/OR REPLACEMENT OF ANY EXISTING IMPROVEMENTS DAMAGED DURING CONSTRUCTION THAT ARE NOT DESIGNATED FOR DEMOLITION AND / OR REMOVAL HEREON. DAMAGED IMPROVEMENTS SHALL BE REPAIRED TO THE SATISFACTION OF THEIR RESPECTIVE OWNERS.
- 12) ANY INTENDED REVISION OF THE HORIZONTAL AND/OR VERTICAL LOCATION OF IMPROVEMENTS TO BE CONSTRUCTED AS SHOWN HEREON SHALL BE REVIEWED AND APPROVED BY ENGINEER PRIOR TO IMPLEMENTATION.

REVISION 1 UPDATES
REVISED WETLAND EDGE AND BUFFERS.
REVISED GRADING.

ELIZABETH C. CASE
N/F DEED BOOK 16394, PAGE 62
PLAN NO. 730 OF 1950

PHILIP & MARY-WREN
N/F DEED BOOK 69885, PAGE 249
PLAN NO. 730 OF 1950

N/F THE CONCORD LAND CONSERVATION TRUST
DEED BOOK 56122, PAGE 203, PLAN NO. 895 OF 2010
PLAN NO. 1036 OF 1980

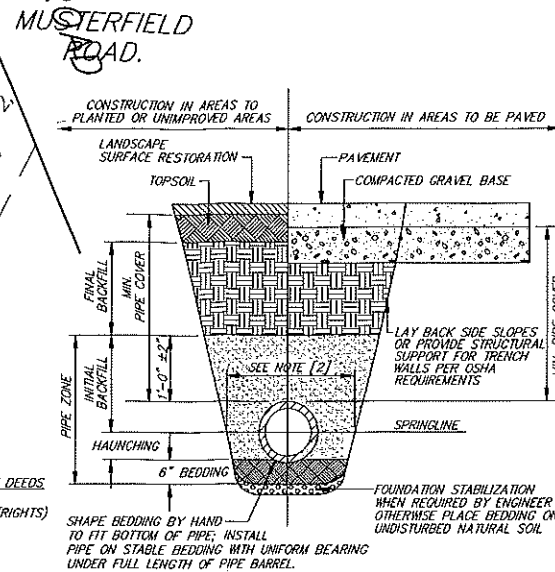
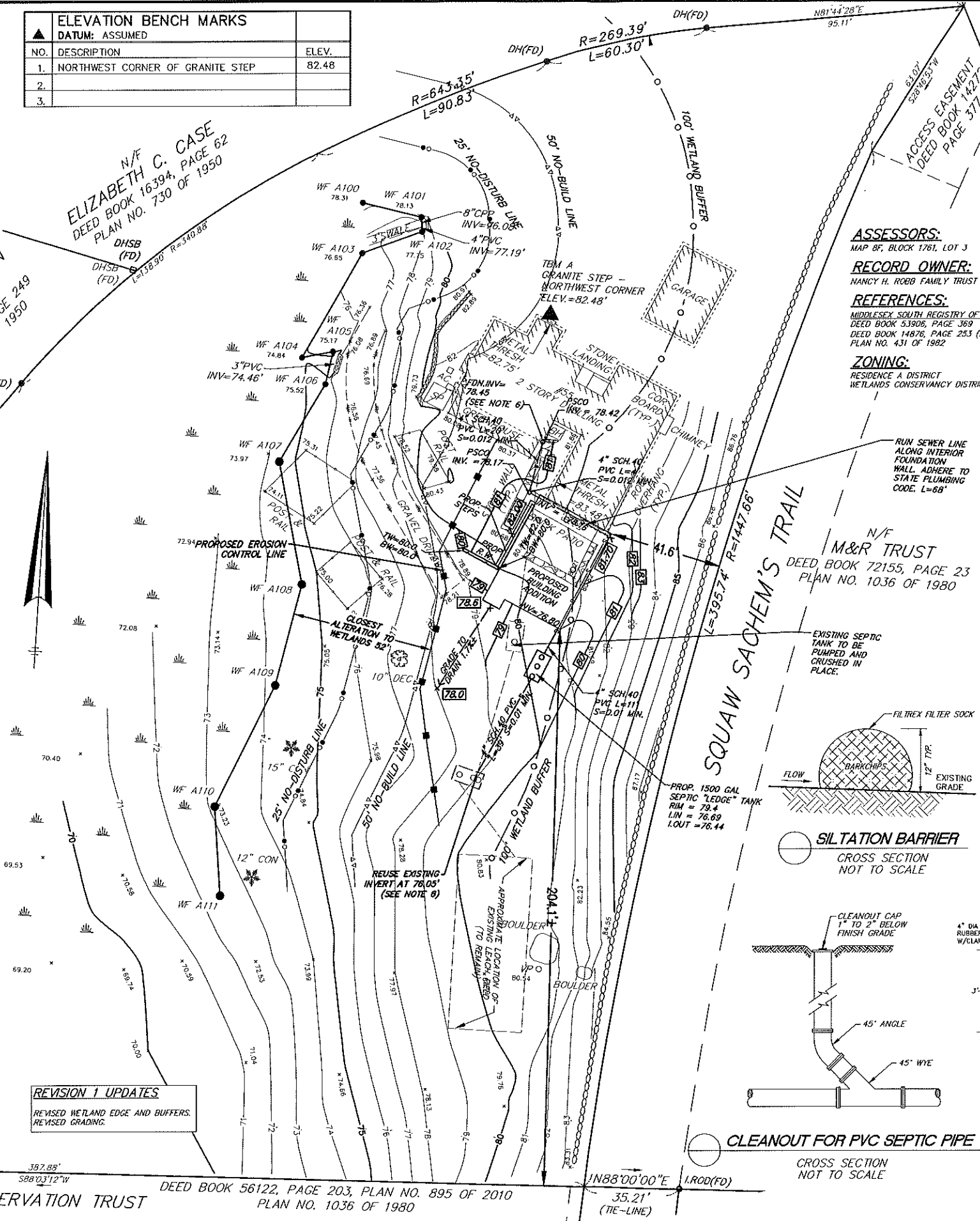

FOUNDATION, BEDDING, & BACKFILL MATERIALS			
PIPE MATERIAL	HDP, PVC	RC, DI	
FOUNDATION STABILIZATION	[6]	[6]	
BEDDING	[1]	[1]	
HAUNCHING	[1]	[1]	
INITIAL BACKFILL	[1]	[1]	
FINAL BACKFILL	[4]	[4]	
MIN. PIPE COVER	[5]	[5]	

- NOTES:**
- [1] PLACE 3/4" GRADED GRANULAR BACKFILL AT OPTIMUM MOISTURE IN HORIZONTAL, 8"-DEEP, LOOSE LAYERS; COMPACT TO 95% PER ASTM D-1557.
 - [2] MINIMUM WIDTH OF TRENCH MEASURED AT THE SPRINGLINE OF THE PIPE, INCLUDING ANY NECESSARY SHEATHING.
 - [3] INSTALL PIPE IN CENTER OF TRENCH.
 - [4] IN PLANTED OR UNIMPROVED AREAS, USE ON-SITE EXCAVATED MATERIAL FOR FINAL BACKFILL. COMPACT TO 95% PER ASTM D-1557. IN PAVED AREAS, OBTAIN ENGINEER APPROVAL OF ON-SITE EXCAVATED MATERIALS FOR USE AS FINAL BACKFILL.
 - [5] MINIMUM COVER OVER TOP OF PIPE:

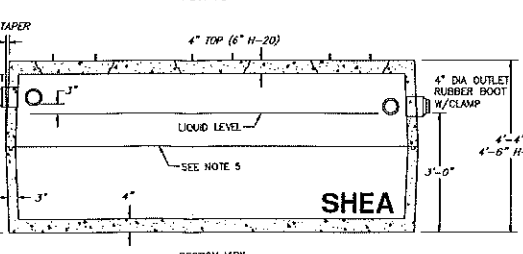
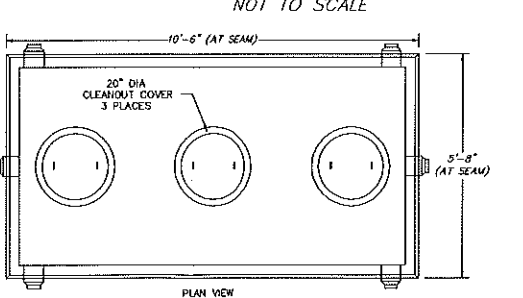
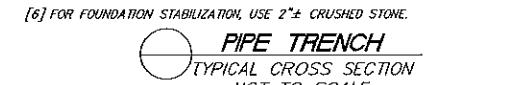

- NOTES:**
1. CONCRETE: 4,000 PSI MINIMUM AFTER 28 DAYS.
 2. CONSTRUCTION OF SEPTIC TANK CONFORMS WITH 310 CUR, SECTION 15.00 DEP TITLE 5 REGS, FOR REPLACEMENT SYSTEMS WHERE A LIQUID LEVEL OF 4" IS NOT FEASIBLE.
 3. ALL REINFORCEMENT PER ASTM C1227.
 4. TEES AND GAS BAFFLE SOLD SEPARATELY.
 5. TONGUE & GROOVE JOINT SEALED WITH BUTYL RESIN.
 6. IF COVER EXCEEDS 4 FEET, HEAVY DUTY TANK REQUIRED. ALSO AVAILABLE IN AASHTO HS-20 LOADING.

SCALE: 1" = 20'

SITE ADDRESS

#55 MUSTERFIELD ROAD

Concord, Massachusetts

PREPARED FOR

GEORGE A. ROBB

55 Musterfield Road
Concord, Massachusetts 01742

HANCOCK ASSOCIATES

Civil Engineers
Land Surveyors
Wetland Scientists

34 CHELMSFORD ST., CHELMSFORD, MA 01824
VOICE (978) 244-0110, FAX (978) 244-1133
WWW.HANCOCKASSOCIATES.COM

1 RD JP 12/18/19 REVISE WETLAND FLAGS

NO. BY APP DATE ISSUE/REVISION DESCRIPTION

DATE: 10/17/19 DRAWN BY: JTL
SCALE: 1"=20' CHECK BY: JP

SEPTIC SYSTEM MODIFICATION PLAN IN CONCORD, MASSACHUSETTS

PROJECT NO.: 22718