



Article 59 Bruce Freeman Rail Trail Easements over Town Land

To determine whether the Town will vote to authorize the Select Board to grant or deed easements over certain town property for an improved multi-use rail trail for non-motorized transportation, open space, and recreation purposes and for all other purposes for which rail trails are now or hereafter may be used in the Commonwealth, or take any other action relative thereto.



Article 59 Bruce Freeman Rail Trail Easements over Town Land

- There are three permanent easements over town land and seven temporary easements.
- Federal highway requires assurance that the Town will allow use of its land for the multi-use rail trail, which the grant of easement will provide.



Article 59 Bruce Freeman Rail Trail Easements over Town Land

Easements are needed over town land for:

- Construction of an access path from Powdermill Road to the Rail Trail.
- Access through the West Concord Commuter Parking Lot and Junction Park.
- Paving
- Clearing & Grubbing, Grading, Loam & Seed



Article 59 Bruce Freeman Rail Trail Easements over Town Land

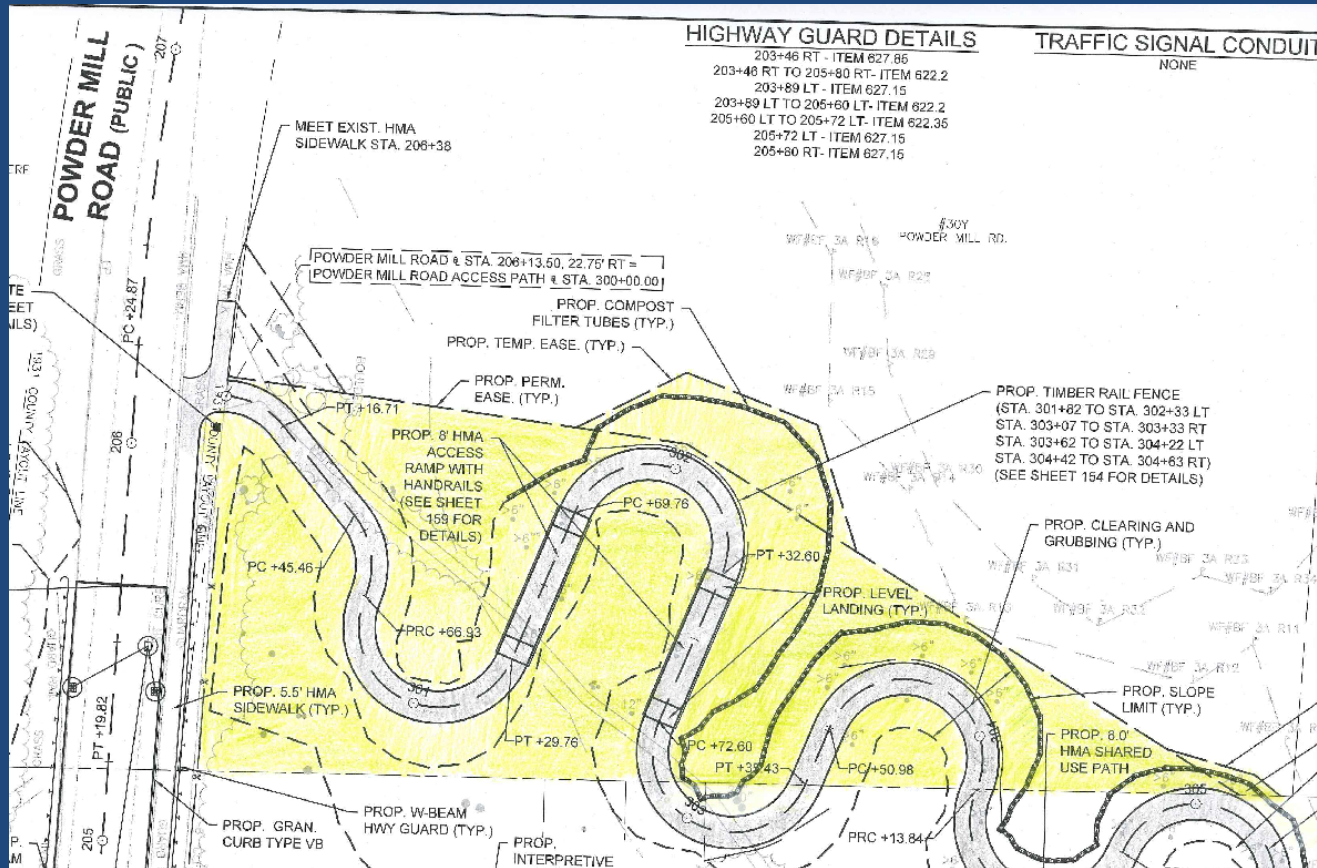

Path over Town land from Powdermill Road to the Rail Trail.



Article 59 Bruce Freeman Rail Trail Easements over Town Land

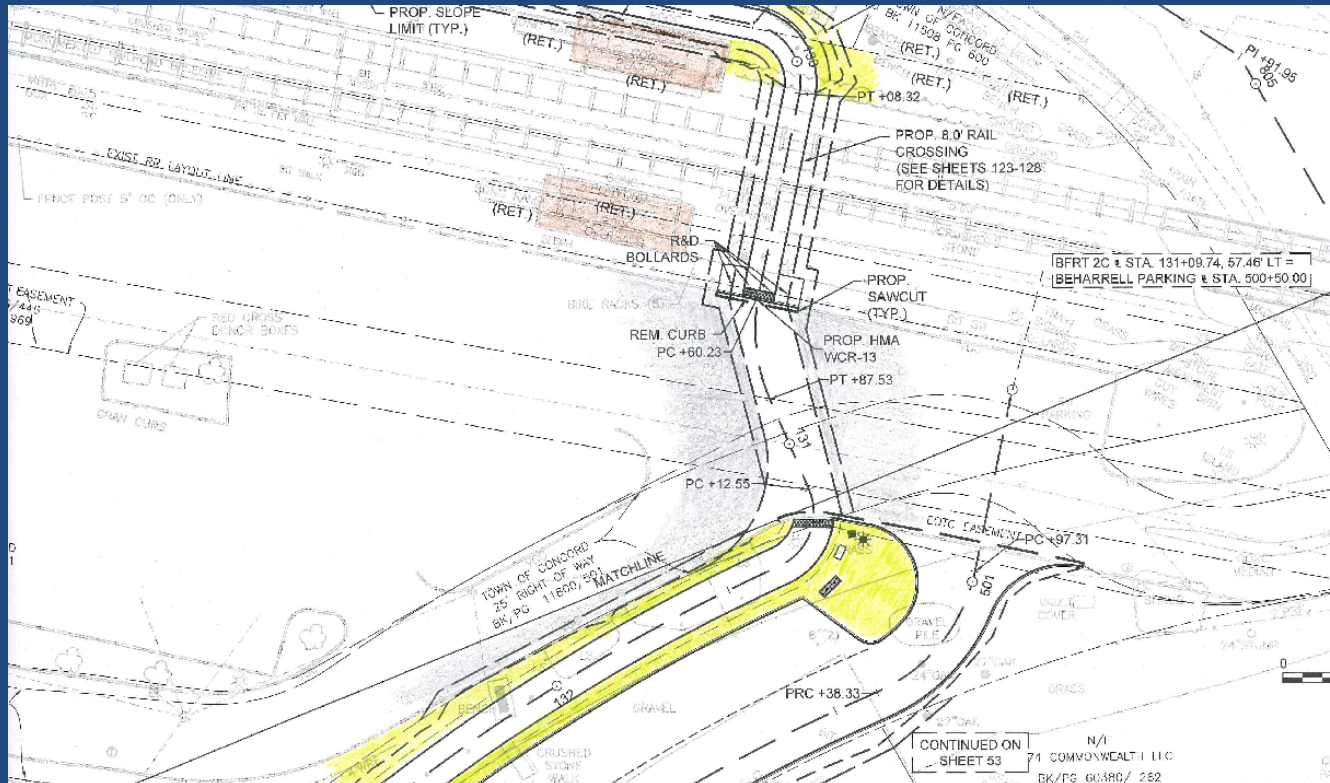

(Rail Trail access through West Concord Commuter Parking Lot)



Article 59 Bruce Freeman Rail Trail Easements over Town Land



Rail Trail access through West Concord Junction Park



Article 59 Bruce Freeman Rail Trail Easements over Town Land

To determine whether the Town will vote to authorize the Select Board to grant or deed easements over certain town property for an improved multi-use rail trail for non-motorized transportation, open space, and recreation purposes and for all other purposes for which rail trails are now or hereafter may be used in the Commonwealth, or take any other action relative thereto.